

Report To:	Inverclyde Council	Date: 6 June 2019
Report By:	Corporate Director, Environment, Regeneration and Resources	Report No: LP/080/19
Contact Officer:	Lindsay Carrick	Contact No: 712114
Subject:	Proposed Traffic Regulation Order – The Inverclyde Council, Disabled Persons’ Parking Places (On Street) Order No. 2 2019	

1.0 PURPOSE

- 1.1 The purpose of this report is to request the Council to consider a remit from the Environment & Regeneration Committee.

2.0 SUMMARY

- 2.1 The Environment & Regeneration Committee held on 2 May 2019 after consideration of a report by the Corporate Director Environment, Regeneration & Resources on the proposed Traffic Regulation Order – The Inverclyde Council, Disabled Persons’ Parking Places (On Street) Order No. 2 2019 recommended that the Inverclyde Council be asked to make the Traffic Regulation Order and to remit it to the Shared Head of Service Roads and the Head of Legal and Property Services to arrange for its implementation.

3.0 RECOMMENDATION

- 3.1 That the Inverclyde Council approves the making of the Traffic Regulation Order – The Inverclyde Council, Disabled Persons’ Parking Places (On Street) Order No. 2 2019 and that the Shared Head of Service Roads and the Head of Legal and Property Services be authorised to take all necessary action in connection therewith. Appendix 1

Gerard Malone
Head of Legal and Property Services

4.0 BACKGROUND

- 4.1 Local Authorities are empowered to make Orders under the Road Traffic Regulation and Roads (Scotland) Acts 1984.
- 4.2 The provision of on-street parking places for use by disabled drivers, who are the holders of a Disabled Person's Badge, is regulated by the Disabled Persons' Parking Places (Scotland) Act 2009. Inverclyde Council is required to promote a Traffic Regulation Order to regulate the use of such parking places.
- 4.3 The Council is asked to note that, if approved, the Order may not be implemented until the making of the Order has been advertised to allow any persons who so wish a period of six weeks to question the validity of the Order in terms of the Road Traffic Regulation Act 1984.

5.0 IMPLICATIONS

Finance

- 5.1 There are no financial implications arising from this report.

Legal

- 5.2 There are no legal implications arising from this report.

Human Resources

- 5.3 There are no HR implications arising from this report.

Equalities

- 5.4 There are no equalities implications arising from this report.

Repopulation

- 5.5 There are no repopulation implications arising from this report.

6.0 CONSULTATIONS

- 6.1 The proposals have been advertised in the Greenock Telegraph and full details of the proposals have been made available for public inspection during normal office hours at the offices of the Shared Head of Service Roads, the Customer Service Centre, and at Central, Gourock, Port Glasgow and Southwest Libraries.
- 6.2 No objection has been received to the proposed Order.

7.0 LIST OF BACKGROUND PAPERS

- 7.1 None

THE INVERCLYDE COUNCIL
DISABLED PERSONS' PARKING PLACES
(ON-STREET) ORDER NO. 2 2019
TRAFFIC REGULATION ORDER

DRAFT

THE INVERCLYDE COUNCIL
DISABLED PERSONS' PARKING PLACES (ON-STREET)
ORDER NO. 2 2019

The Inverclyde Council in exercise of the powers conferred on them by Section 32(1) of the Road Traffic Regulation Act 1984 ("the Act") and of all other enabling powers and after consultation with the Chief Constable of Police Scotland in accordance with Part III of Schedule 9 to the Act hereby make the following Order.

1. This Order may be cited as "The Inverclyde Council Disabled Persons' Parking Places (On-Street) Order No. 2 2019" and shall come into operation on ?????????

2. In this Order the following expressions have the meanings hereby assigned to them:-

"Council" means The Inverclyde Council or its successors as Roads Authority;

"disabled person's badge" means:

- (a) a badge issued under Section 21 of the Chronically Sick and Disabled Persons Act 1970 (as amended);
- (b) a badge issued under a provision of the law of Northern Ireland corresponding to that section; or
- (c) a badge issued by any member State other than the United Kingdom for purposes corresponding to the purposes for which badges under that section are issued;

and which has not ceased to be in force;

"disabled person's vehicle" means a vehicle lawfully displaying a disabled person's badge;

"parking attendant" means a person employed in accordance with Section 63A of the Act to carry out the functions therein;

"parking place" means an area of land specified by number and name in Columns 1 and 2 in the Schedule to this Order;

"traffic sign" means a sign prescribed or authorised under Section 64 of the Act; and

"vehicle" unless the context otherwise requires, means a vehicle of any description and includes a machine or implement of any kind drawn or propelled along roads whether or not by mechanical power.

3. The Schedule titled "Disabled Persons' Parking Places (On Street) Order No. 2 2019" forms the Schedule to this Order.

4. Each area of road which is described in the Schedule Part 1 to this Order and the plans relative to this Order is hereby designated as a parking place.

5. The parking places shall only be used for the leaving of disabled persons' vehicles displaying a valid disabled person's badge.

6. The limits of each parking place shall be indicated on the carriageway as prescribed by The Traffic Signs Regulations and General Directions 2016, as amended.

7. Every vehicle left in any parking place shall stand such that no parking place is occupied by more than one vehicle and that every part of the vehicle is within the limits of the parking place provided that, where the length of a vehicle precludes compliance with this paragraph, such vehicle shall be deemed to be within the limits of a parking place if:-

the extreme front portion or, as the case may be, the extreme rear portion of the vehicle is within 300mm of an indication on the carriageway provided under this Order in relation to the parking place; and

the vehicle, or any part thereof, is not within the limits of any adjoining parking place.

8. Any person duly authorised by the Council or a police officer in uniform or a traffic warden or parking attendant may move or cause to be moved in case of any emergency, to any place they think fit, vehicles left in a parking place.

9. Any person duly authorised by the Council may suspend the use of a parking place or any part thereof whenever such suspension is considered reasonably necessary:-

for the purpose of facilitating the movement of traffic or promoting its safety;

for the purpose of any building operation, demolition, or excavation in or adjacent to the parking place or the laying, erection, alteration, removal or repair in or adjacent to the parking place of any sewer or of any main, pipe, apparatus for the supply of gas, water electricity or of any telecommunications apparatus, traffic sign or parking meter;

for the convenience of occupiers of premises adjacent to the parking place on any occasion of the removal of furniture from one office or dwellinghouse to another or the removal of furniture from such premises to a depository or to such premises from a depository;

on any occasion on which it is likely by reason of some special attraction that any street will be thronged or obstructed; or

for the convenience of occupiers of premises adjacent to the parking place at times of weddings or funerals or on other special occasions.

10. A police officer in uniform may suspend for not longer than twenty four hours the use of a parking place or part thereof whenever such suspension is considered reasonably necessary for the purpose of facilitating the movement of traffic or promoting its safety.

11. This Order insofar as it relates to the parking places to be revoked (R) and amended, as specified in the Schedule Part 2 to this Order, partially revokes and amends The Inverclyde Council Disabled Persons' Parking Places (On-Street) Order Nos.01/2001, 01/2004, 01/2010, 02/2008, 02/2010 and 02/2013 respectively.

Sealed with the Common Seal of The Inverclyde Council and subscribed for them and on their behalf by ????????????, Proper Officer, on the ?????????? day of ????????, Two Thousand and ????????????

DRAFT

INVERCLYDE COUNCIL

**DISABLED PERSONS' PARKING PLACES (ON-STREET)
ORDER No.2 2019**

Rev A

SCHEDULE (Part 1)

All and whole that area of ground as described in Column 2 in the table below:

Column 1	Column 2
<u>Ref No.</u>	<u>Address of Disabled Person's Parking Place to be created "ex-adverso"</u>
1874	19 West Road, Port Glasgow
1875	4 Binnie Street, Gourock
1877	35 Robertson Street, Greenock
1878	2b Ashburn Gate, Gourock
1879	24 Bute Avenue, Port Glasgow
1883	17 Prospecthill Street, Greenock
1884	5 Lewis Road, Port Glasgow
1885	108 Pennyfern Road, Greenock



© Crown Copyright and database right 2018.
 All rights reserved.
 Ordnance survey Licence number 100023421.

DISABLED PERSONS' PARKING PLACE
19 WEST ROAD, PORT GLASGOW
PLACE No. 1874

Inverclyde council
 Environment and Public Protection

Environment, Regeneration & Resources
 Corporate Director: Scott Allan BSc., C.Eng., M.I.C.E.
 Municipal Buildings
 Clyde Square
 Greenock
 PA15 1LY
 Tel: 01475 712712
 Fax: 01475 712731
 scott.allan@inverclyde.gov.uk



©Crown Copyright and database right 2018.
 All rights reserved.
 Ordnance survey Licence number: 100023421.

DISABLED PERSONS' PARKING PLACE
4 BINNIE STREET, GOUROCK
PLACE No. 1875



Environment, Regeneration & Resources
 Corporate Director: Scott Allan BSc., C.Eng., M.I.C.E.
 Municipal Buildings
 Clyde Square
 Greenock
 PA15 1LY
 Tel: 01475 712712
 Fax: 01475 712731
 scott.allan@inverclyde.gov.uk



© Crown Copyright and database right 2018.
 All rights reserved.
 Ordnance Survey Licence number 100023421.

DISABLED PERSONS' PARKING PLACE
35 ROBERTON STREET, GREENOCK
PLACE No. 1877

Inverclyde
 council
 Environment and Public Protection

Environment, Regeneration & Resources
 Corporate Director: Scott Allan BSc., C.Eng., M.I.C.E.
 Municipal Buildings
 Clyde Square
 Greenock
 PA15 1LY
 Tel: 01475 712712
 Fax: 01475 712731
 scott.allan@inverclyde.gov.uk

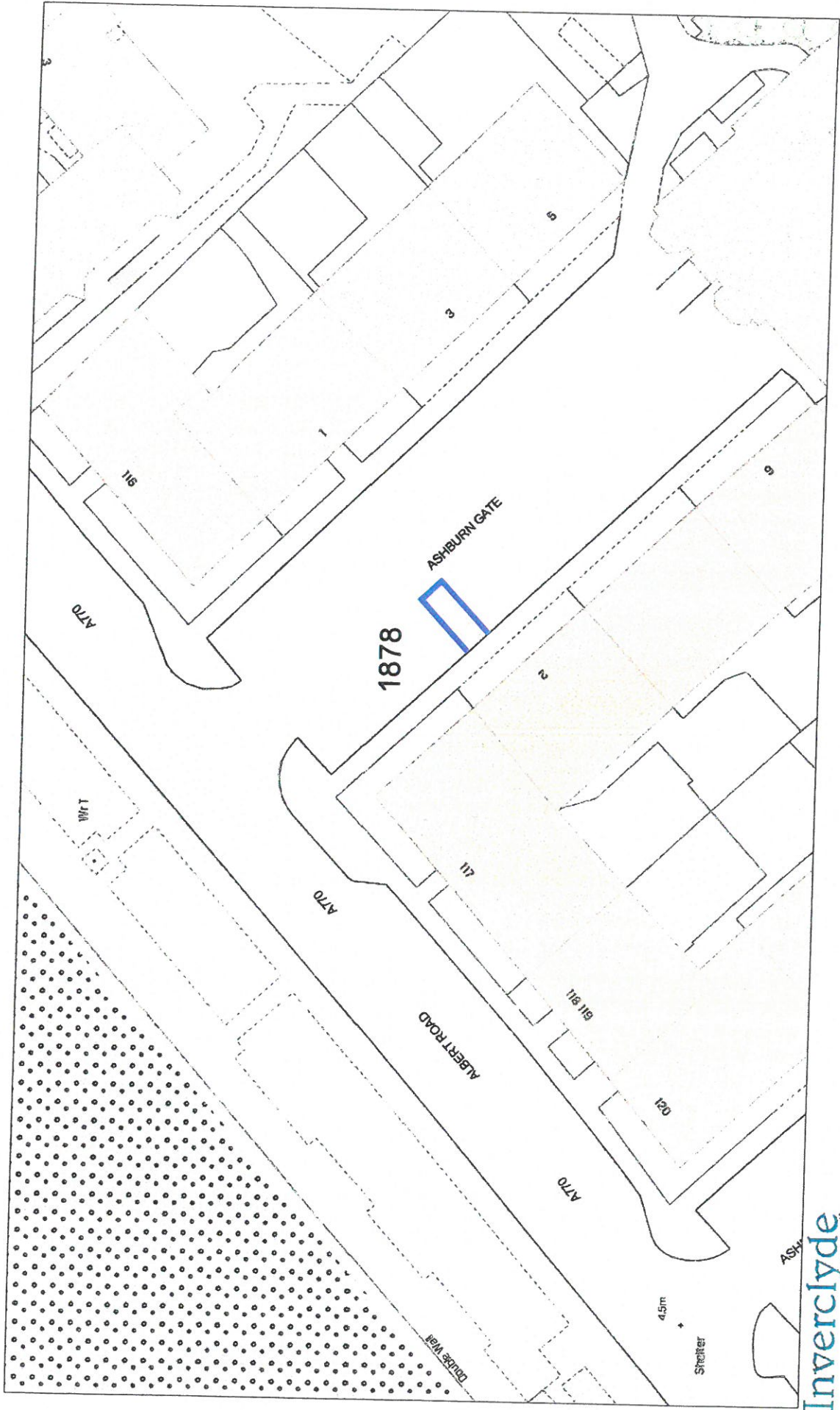

DISABLED PERSONS' PARKING PLACE
2b ASHBURN GATE, GOUROCK
PLACE No. 1878



© Crown Copyright and database right 2018.
 All rights reserved.
 Ordnance survey Licence number 100023421.

Inverclyde council
 Environment and Public Protection

Environment, Regeneration & Resources
 Corporate Director: Scott Allan BSc., C.Eng., M.I.C.E.
 Municipal Buildings
 Clyde Square
 Greenock
 PA15 1LY
 Tel: 01475 712712
 Fax: 01475 712731
 scott.allan@inverclyde.gov.uk

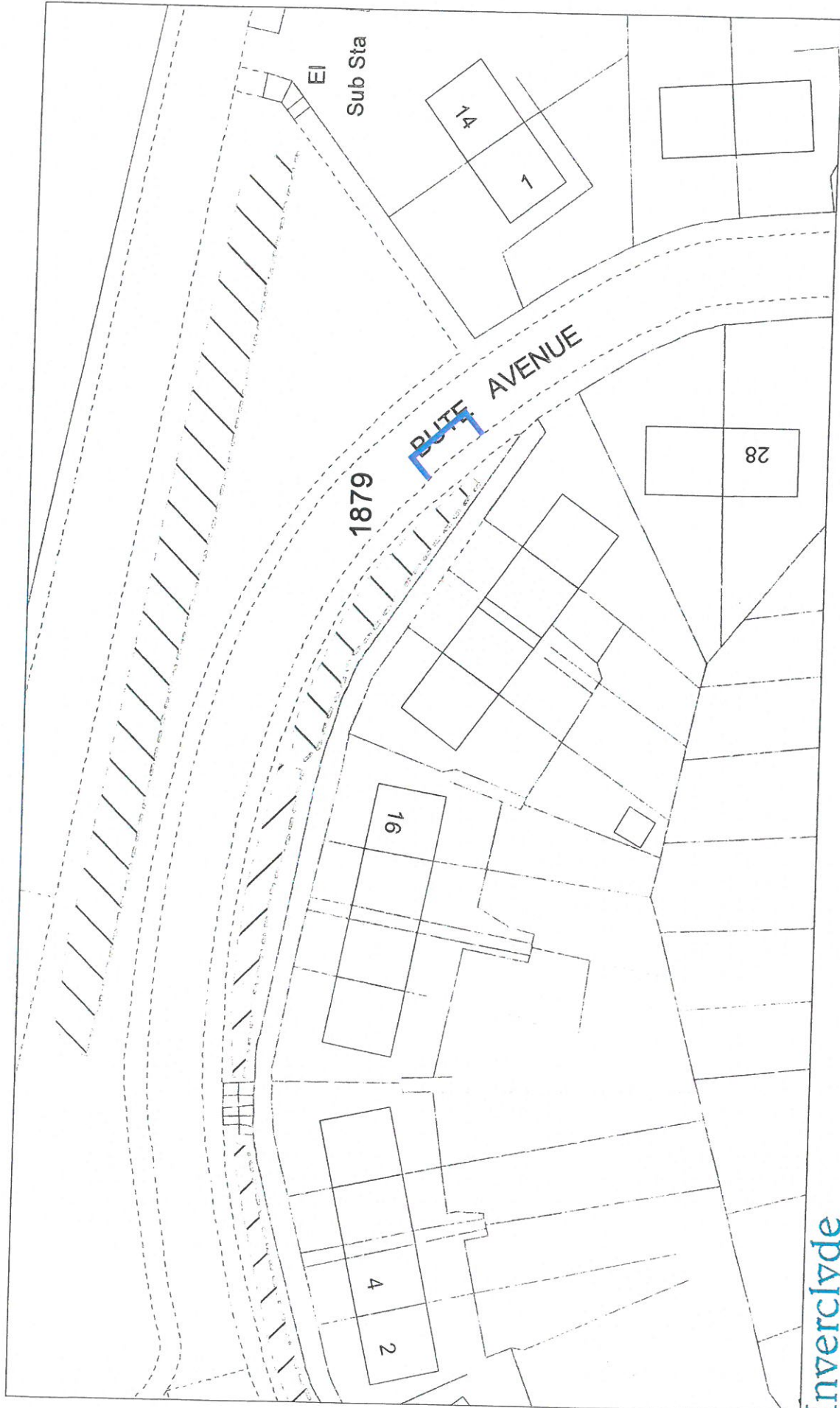

© Crown Copyright and database right 2018.
 All rights reserved.
 Ordnance survey Licence number 100023421.

DISABLED PERSONS' PARKING PLACE
24 BUTE AVENUE, PORT GLASGOW
PLACE No. 1879

Inverclyde Council
 Environment and Public Protection

Environment, Regeneration & Resources
 Corporate Director: Scott Allan BSc., C.Eng., M.I.C.E

Municipal Buildings
 Clyde Square
 Greenock
 PA15 1LY
 Tel: 01475 712712
 Fax: 01475 712731
 scott.allan@inverclyde.gov.uk

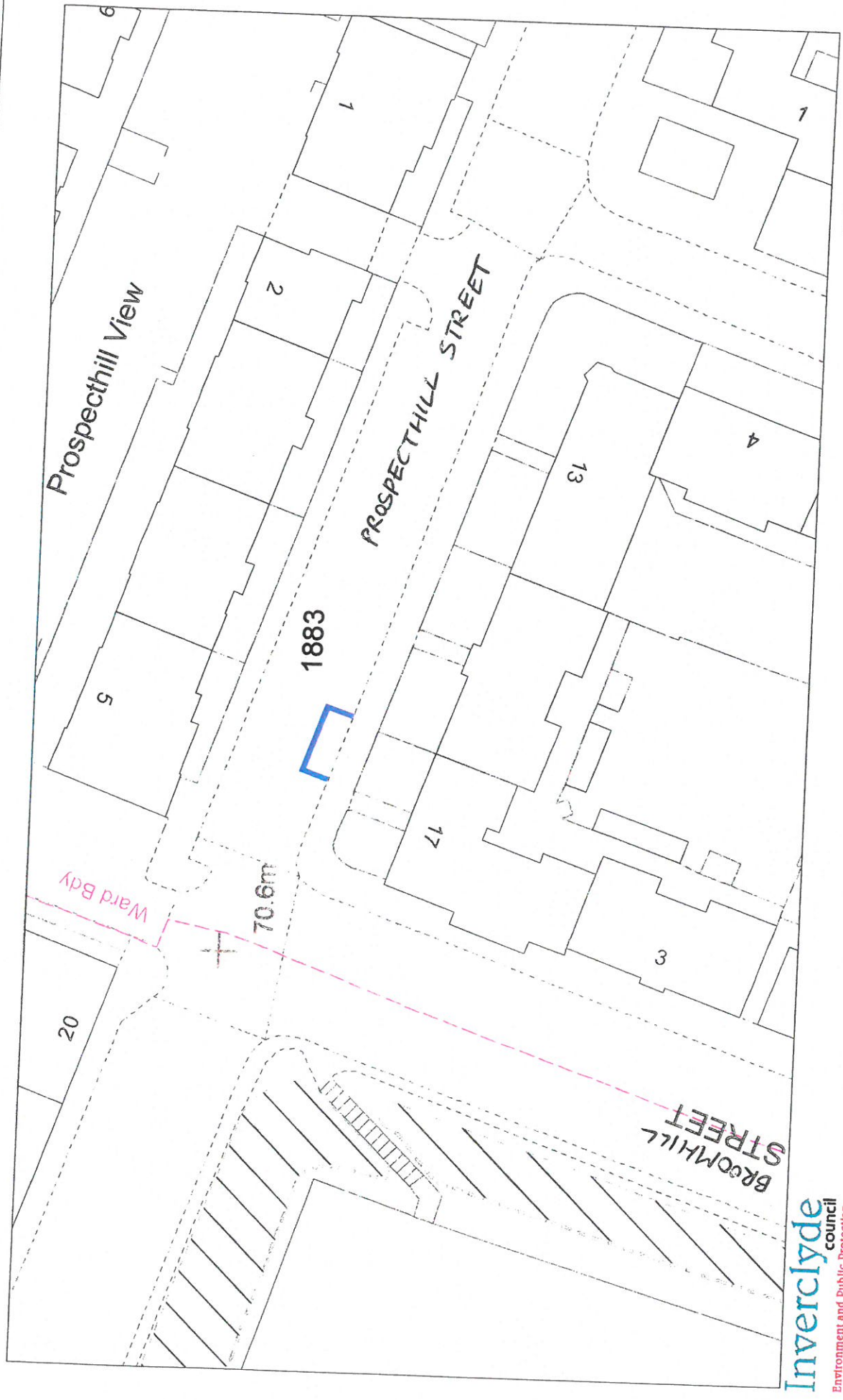

© Crown Copyright and database right 2018.
 All rights reserved.
 Ordnance survey Licence number 100023421.

DISABLED PERSONS' PARKING PLACE
17 PROSPECTHILL STREET, GREENOCK
PLACE No. 1883

Inverclyde
council
 Environment and Public Protection

Environment, Regeneration & Resources
 Corporate Director: Scott Allan BSc., C.Eng., M.I.C.E.
 Municipal Buildings
 Clyde Square
 Greenock
 PA15 1LY
 Tel: 01475 712712
 Fax: 01475 712731
 scott.allan@inverclyde.gov.uk



© Crown Copyright and database right 2018.
 All rights reserved.
 Ordnance survey Licence number 100023421.

DISABLED PERSONS' PARKING PLACE
5 LEWIS ROAD, PORT GLASGOW
PLACE No. 1884

AVENUE

Inverclyde
council
 Environment and Public Protection

Environment, Regeneration & Resources
 Corporate Director: Scott Allan BSc., C.Eng., M.I.C.E.
 Municipal Buildings
 Clyde Square
 Greenock
 PA15 1LY
 Tel: 01475 712712
 Fax: 01475 712731
 scott.allan@inverclyde.gov.uk

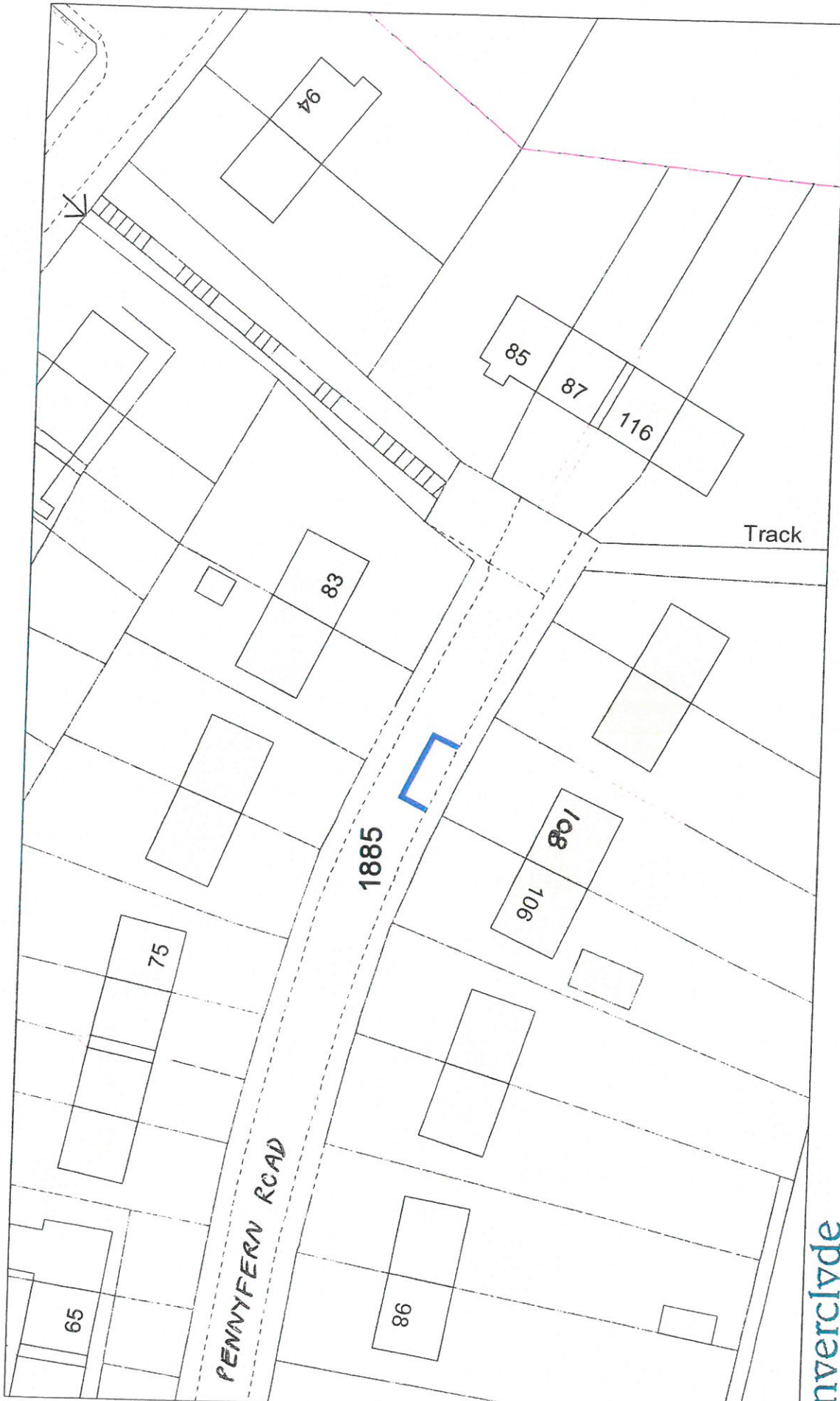

© Crown Copyright and database right 2018.
 All rights reserved.
 Ordnance survey Licence number 100023421.

Inverclyde
 council
 Environment and Public Protection

Environment, Regeneration & Resources
 Corporate Director: Scott Allan BSc., C.Eng., M.I.C.E.
 Municipal Buildings
 Clyde Square
 Greenock
 PA15 1LJ
 Tel: 01475 712712
 Fax: 01475 712731
 scott.allan@inverclyde.gov.uk

DISABLED PERSONS' PARKING PLACE
 108 PENNYFERN ROAD, GREENOCK
 PLACE No. 1885



© Crown Copyright and database right 2018.
 All rights reserved.
 Ordnance survey Licence number 100023421.

DISABLED PERSONS' PARKING PLACE
6 DYKENEUK ROAD, PORT GLASGOW
PLACE No. 0033 REVOCATION



Environment, Regeneration & Resources
 Corporate Director: Scott Allan BSc., C.Eng., M.I.C.E.
 Municipal Buildings
 Clyde Square
 Greenock
 PA15 1LY
 Tel: 01475 712712
 Fax: 01475 712731
 scott.allan@inverclyde.gov.uk



HEAD OF SERVICE
ALAN G BARNES MCIWM CEMV

71 EAST HAMILTON STREET
GREENOCK, PA15 2UA

Reproduced from Ordnance Survey mapping with the permission of the Controller of Her Majesty's Stationery Office. Crown Copyright. All rights reserved. Unauthorised reproduction infringes Crown Copyright and may result in prosecution or legal proceedings.

Licence No. LA03097L

DISABLED PERSONS' PARKING PLACE
11 GLEN AVENUE, PORT GLASGOW
PLACES Nos. 0410 & 0941 REVOCATION

Scale : 1:500
Prepared by : R. MACKAY
Drawn by : R. MACKAY
Drawing No. :

Date : NOV 2009
Checked by :
Approved by :
File No. : 19/12

Disabled Bays

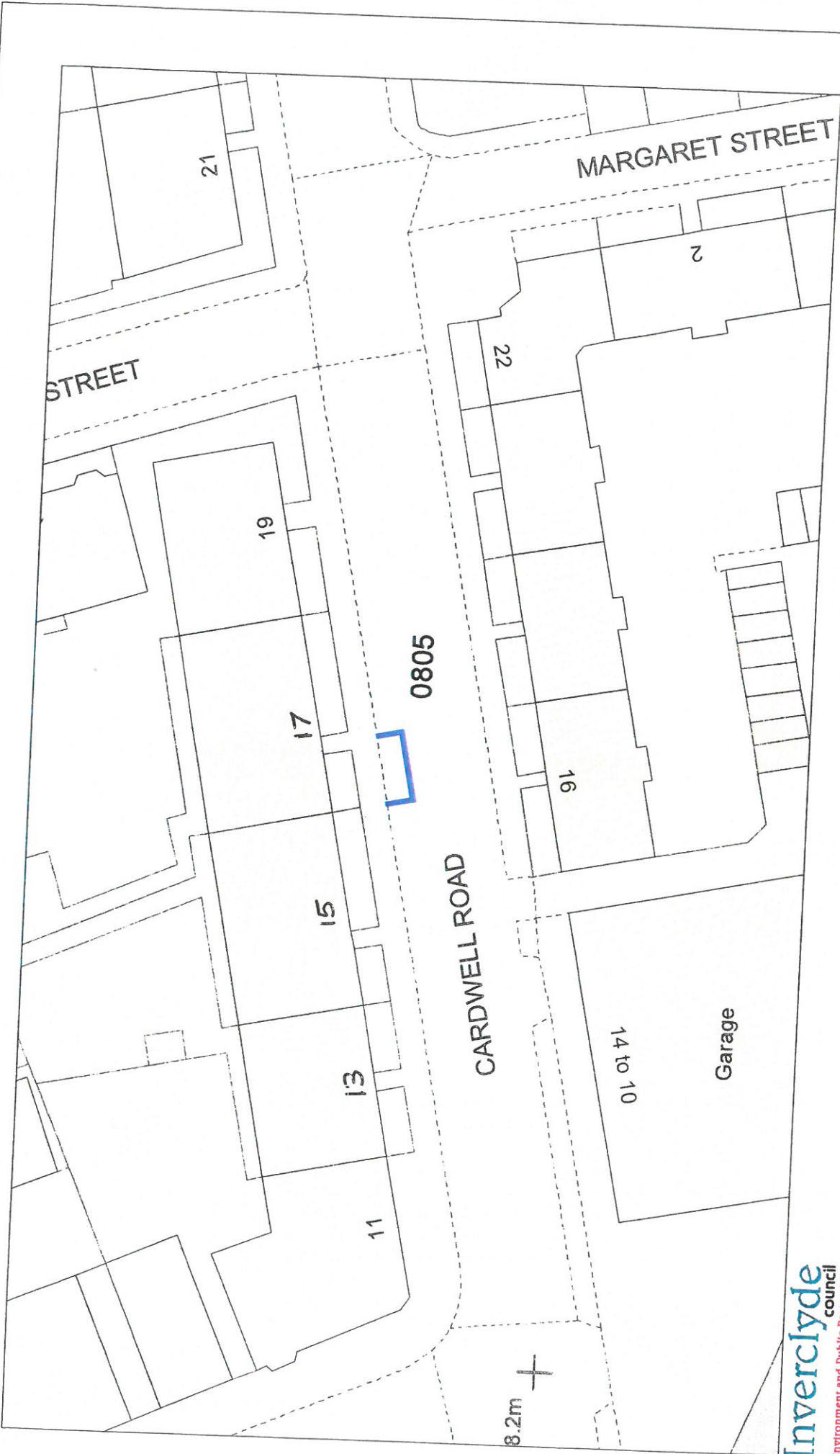

© Crown Copyright and database right 2018.
 All rights reserved.
 Ordnance survey Licence number 100023421.

DISABLED PERSONS' PARKING PLACE
15 CARDWELL ROAD, GOUROCK
PLACE No. 0805 REVOCATION

Inverclyde council
 Environment and Public Protection
 Environment, Regeneration & Resources
 Corporate Director: Scott Allen BSc., C.Eng., M.I.C.E.
 Municipal Buildings
 Clyde Square
 Greenock
 PA15 1LY
 Tel: 01475 712712
 Fax: 01475 712731
 scott.allan@inverclyde.gov.uk



HEAD OF SERVICE
ALAN G BARNES MCIWM CERV

71 EAST HAMILTON STREET
GREENOCK, PA15 2UA

Reproduced from Ordnance Survey mapping with the permission of the Controller of Her Majesty's Stationery Office. Crown Copyright. All rights reserved. Unauthorised reproduction infringes Crown Copyright and may result in prosecution or legal proceedings.

Licence No. LA03097L

DISABLED PERSONS' PARKING PLACE
73 BAWHIRLEY ROAD, GREENOCK
PLACE No. 0977 REVOCATION

Scale :	1:500	Date :	MAR 2010
Prepared by :	R. MACKAY	Checked by :	
Drawn by :	R. MACKAY	Approved by :	
Drawing No. :		File No. :	19/12

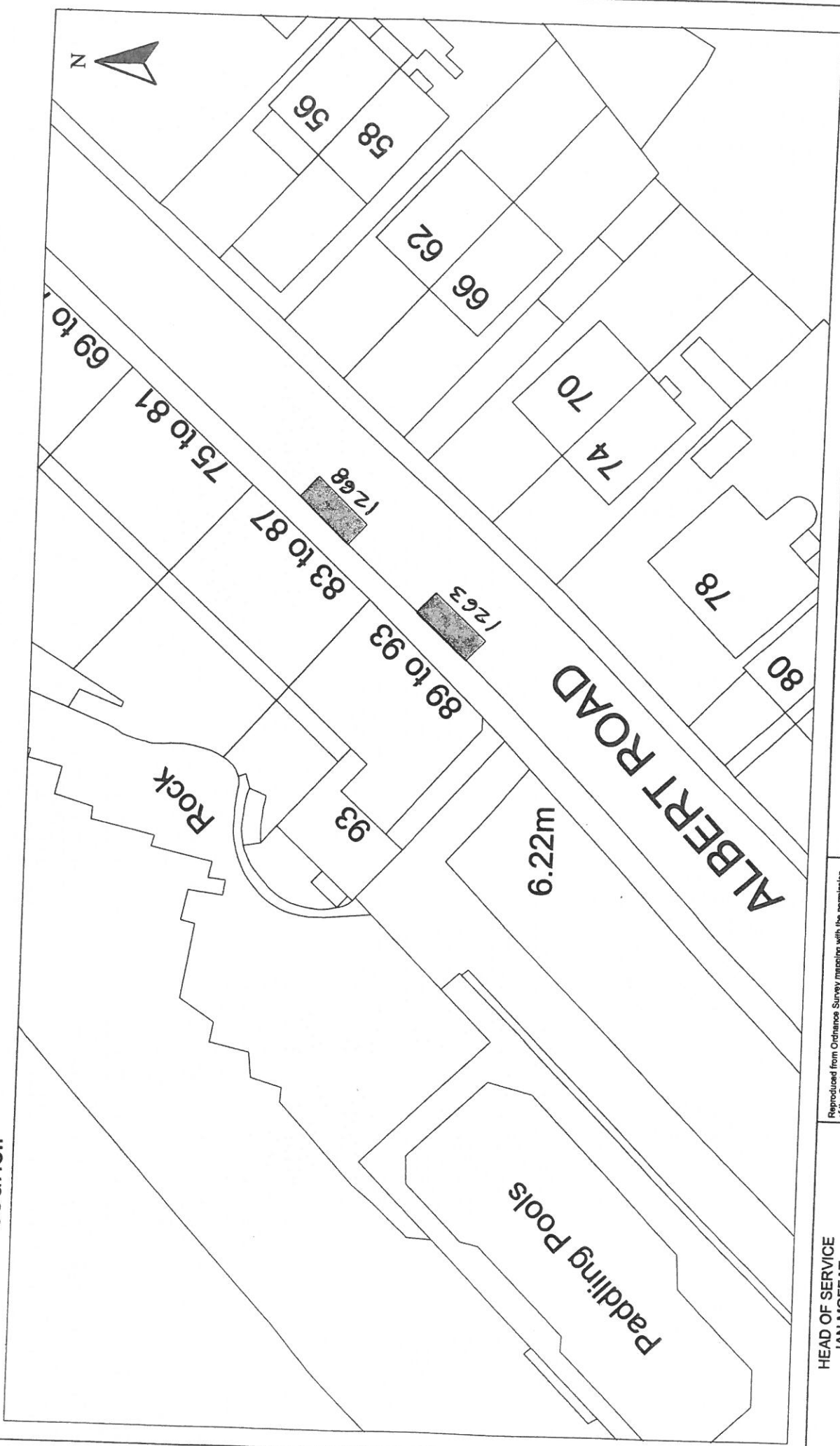

HEAD OF SERVICE
IAN MOFFAT

Disabled Bays
71 EAST HAMILTON STREET
GREENOCK, PA15 2UA

Reproduced from Ordnance Survey mapping with the permission of the Controller of Her Majesty's Stationery Office. Crown Copyright. Unauthorised reproduction may result in prosecution or legal proceedings.

 Licence No. LA03097L

DISABLED PERSONS' PARKING PLACE
85 & 91 ALBERT ROAD, GOUROCK
PLACES Nos. 1263 & 1268 REVOCATION

Scale :	1:500	Date :	JAN 2013
Prepared by :	R. MACKAY	Checked by :	
Drawn by :	R. MACKAY	Approved by :	
Drawing No. :		File No. :	19/12

THE INVERCLYDE COUNCIL

**DISABLED PERSONS' PARKING PLACES
(ON-STREET) ORDER NO. 2 2019**

**Statement of Reasons for Proposing to Make
the above Order**

It is considered necessary, in order to comply with Section 5 of The Disabled Persons' Parking Places (Scotland) Act 2009, to make the above Order to provide assistance for disabled persons who hold a badge under the Disabled Persons (Badges for Motor Vehicles) (Scotland) Regulations 2000 as amended and to revoke those parking places no longer required to maximise street parking capacity.

Gail MacFarlane
Shared Head of Service Roads
GREENOCK
PA15 4UE